



Bishop Beale Duncan
COMMERCIAL REAL ESTATE

5 Windsormere Way, Ste. 200
Oviedo, Florida 32765

MOVE-IN READY OFFICE SPACE



FOR LEASE

- + Lease Rate: \$22.50 / SF MG
Includes CAM
Furnishing negotiable
- + Available: 1,128 SF
- + Bulding Size: 4,089 SF
- + Zoning: R-P



Highlights

- Great accessibility to Highways SR 417, SR 426 (W Broadway Street), SR 434 (Alafaya Trail), CR 419 (W Broadway Street)
- Located in professional office and medical complex with multiple office buildings
- Close proximity to Downtown Oviedo and OOTP restaurants
- 20 Minutes from Downtown Orlando
- 3 Minutes from Downtown Oviedo
- Parking ratio: 3.34 / 1,000 SF
- Small professional office complex, well maintained
- Newly renovated kitchen, restrooms, and cubicles

JONATHAN CLAYTON
Director
(407) 670.9113
Jonathan@BBDRE.com

RUSSELL MAYS
Associate
(407) 734.7209
Russell@BBDRE.com



BISHOP BEALE DUNCAN
250 N. Orange Ave., Ste. 1500
Orlando, FL 32801 + (407) 426.7702
www.BBDRE.com

Floorplan & Images

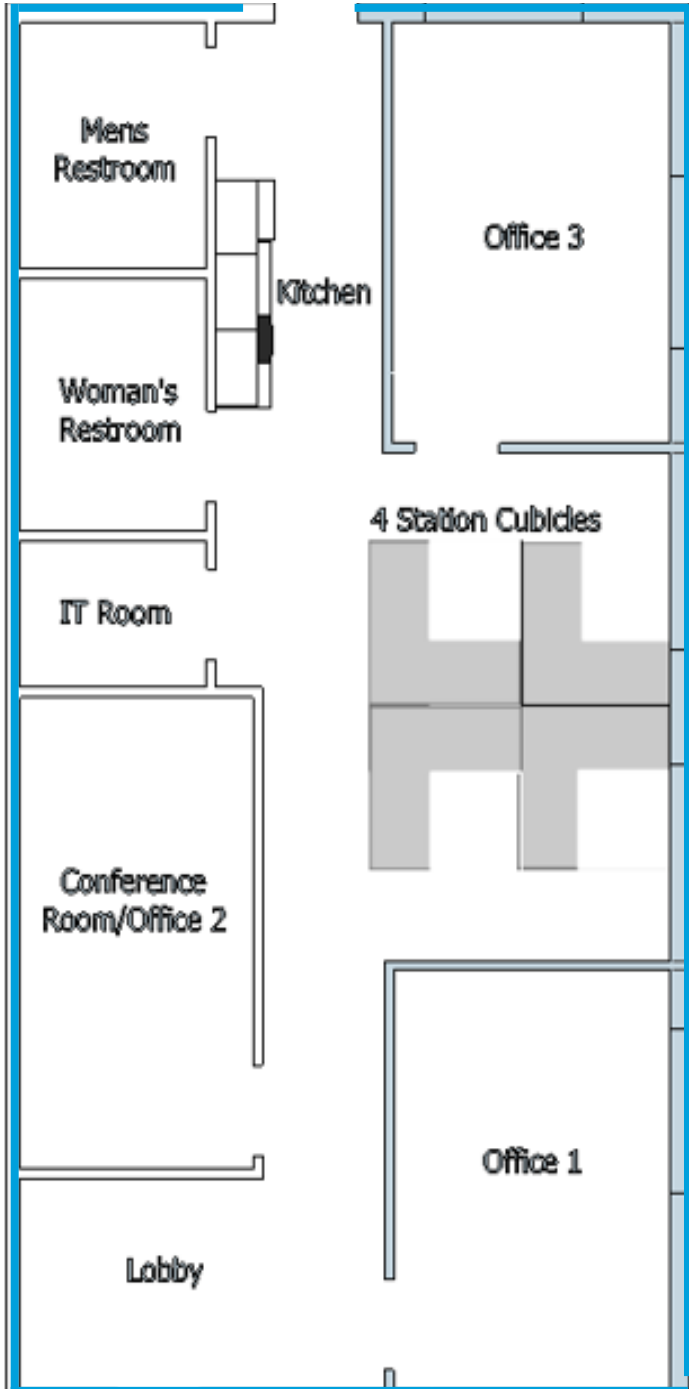

Site Location



Nearby Businesses



Location Aerial & Demographics



| Radius | Population | HH Income | Businesses | Employees |
|--------|------------|-----------|------------|-----------|
| 1-Mile | 6,816 | \$98,363 | 609 | 4,383 |
| 2-Mile | 53,828 | \$110,261 | 2,877 | 18,384 |
| 3-Mile | 135,360 | \$109,081 | 6,422 | 45,830 |

