



Bishop Beale Duncan
COMMERCIAL REAL ESTATE

12554 South John Young Parkway
Suite 105
Orlando, Florida 32837

FULLY BUILT-OUT READY-TO-OCCUPY OFFICE



FOR LEASE

- + Lease Rate: \$23.00 / SF NNN
- + Available SF: 1,600 SF
- + Primary Type: Medical / Office
- + Signage: Monument

Highlights

- Located Near the Hunter's Creek Community, with Close Access to the FL 417
- Within a Primarily Medical Office Complex
- Fully Built-out & Ready-to-Occupy Office/ Medical Office Space
- Ample Parking
- Office Amenities: Five Offices/Exam Rooms, Two Rest Rooms, Break Area, Storage Space, Large Waiting Area, and Reception Area
- Co-Tenants: Optical, Chiropractor, Pediatrics and Dentist



PATRICK GOETZ

Vice President
(407) 734.7210
Pat@BBDRE.com

This offer is subject to errors, omissions, prior sale or withdrawal without notice.



BISHOP BEALE DUNCAN

250 N. Orange Ave., Ste. 1500
Orlando, FL 32801 + (407) 426.7702

www.BBDRE.com

Floor Plan & Images

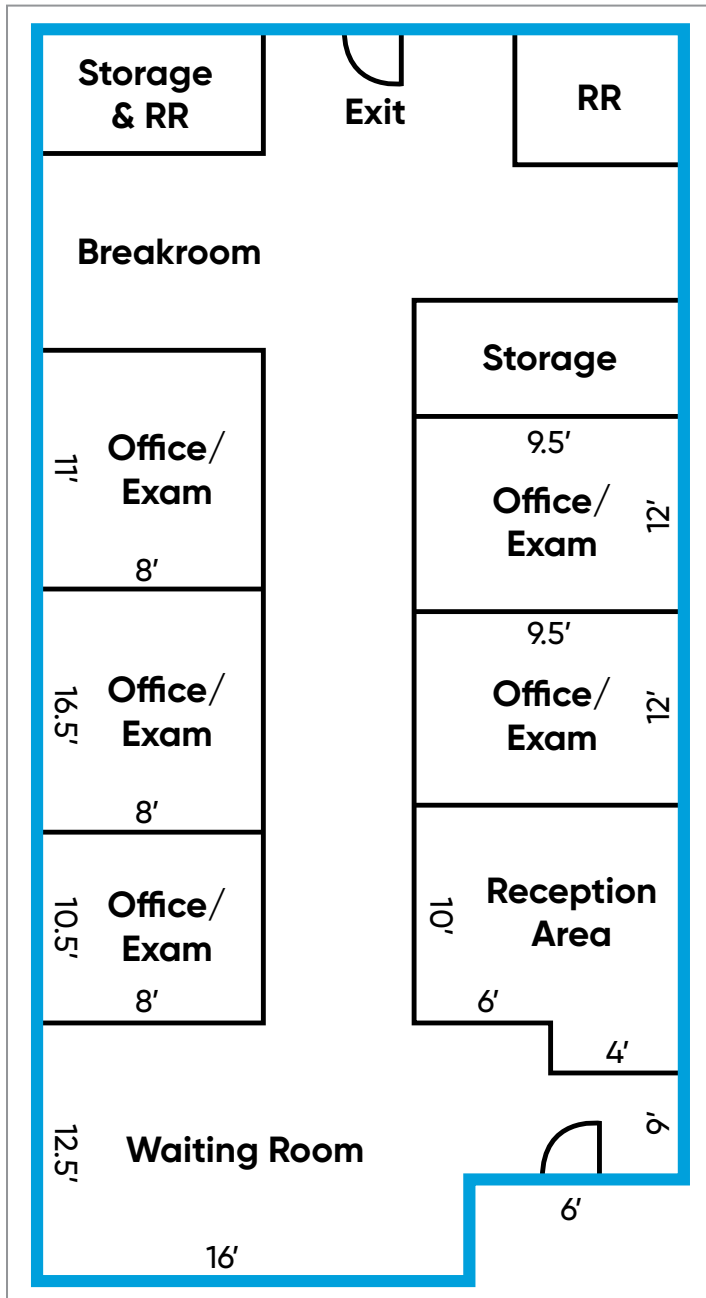

AMENITIES

- 1,600 SF
- Five Offices / Exam Rooms
- Two Rest Rooms
- Break Area
- Storage Space
- Large Waiting Area
- Reception Area

