



Bishop Beale Duncan
COMMERCIAL REAL ESTATE

1620 North Goldenrod Road
Orlando, Florida 32807

OFFICE + WAREHOUSE/FLEX SPACE



For Lease

- + Lease Rate: \$8.95 / SF NNN
- + Available SF: 21,500 SF
- + Land Size: 50,876 SF
- + Zoning: C-3

Highlights

- Located Just Off East Colonial Drive on Goldenrod Road
- 3,276 SF Office/Showroom Recently Renovated
- Covered Walkway Connecting to an 18,000 SF Warehouse/Flex Building
- Grade Level Loading with Five 15' x 15' Doors
- 25 Parking Spaces + Yard
- 18' Clear Height
- Access Available from Colonial Drive and Goldenrod Road
- Outdoor Storage
- Building & Pole Signage



PATRICK GOETZ

Vice President
(407) 734.7210
Pat@BBDRE.com

This offer is subject to errors, omissions, prior sale or withdrawal without notice.



BISHOP BEALE DUNCAN

250 N. Orange Ave., Ste. 1500
Orlando, FL 32801 + (407) 426.7702

www.BBDRE.com

Floor Plan & Images

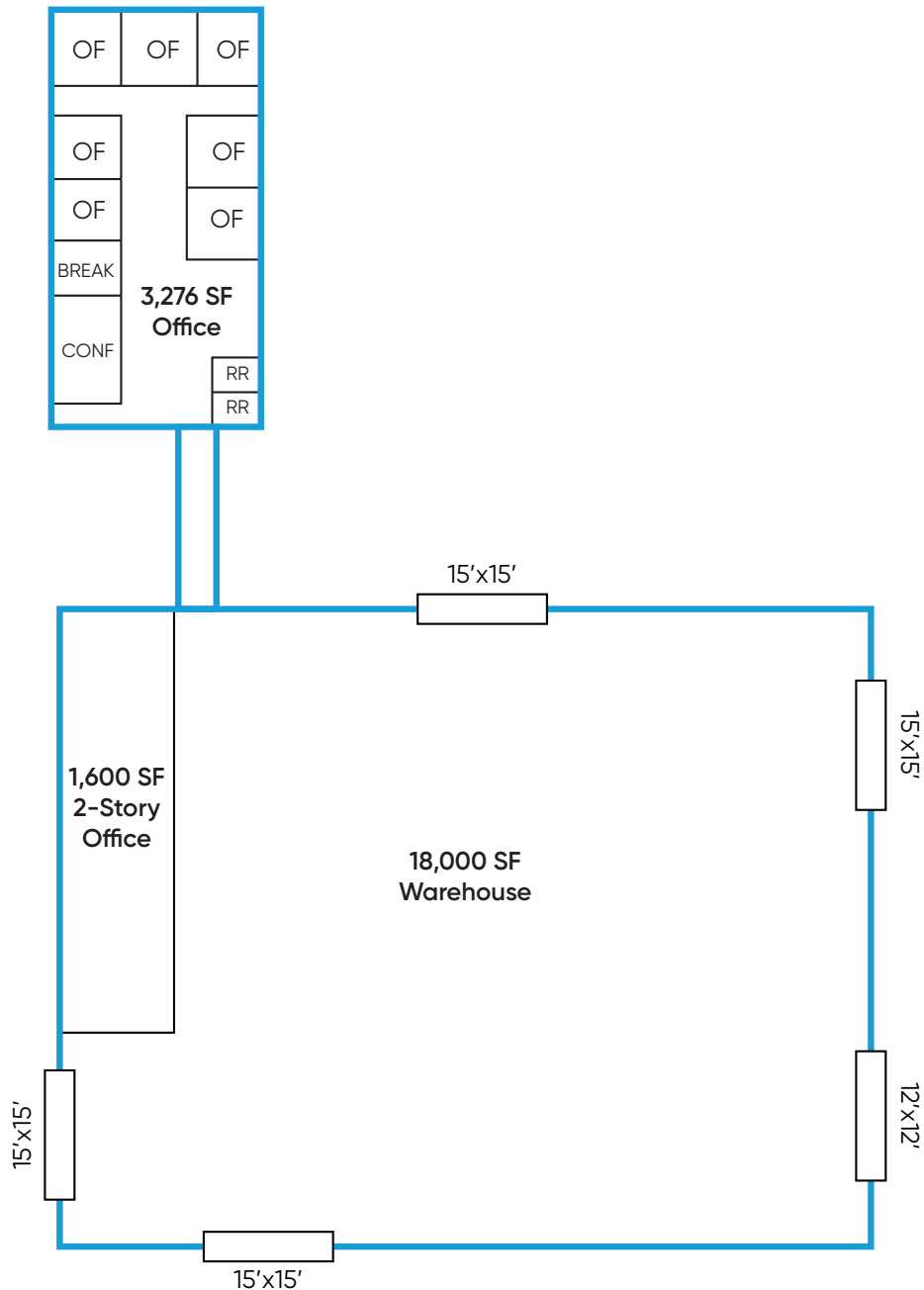

AMENITIES

- 7 Private Offices
- Break Room
- Conference Room
- Private Restrooms
- Connected Walkway to Warehouse
- 3,276 SF Office Space
- 18,000 SF Warehouse with a 1,600 SF 2-Story Office
- 5 Grade Level Doors
- 15' x 15' Clear Height
- Outside Storage

