



Bishop Beale Duncan  
COMMERCIAL REAL ESTATE

7006 Stapoint Court  
Winter Park, Florida 32792

**IND. FLEX/WAREHOUSE/OFFICE SPACE**



## For Lease

- + Lease Rate: \$9.95 / SF NNN
- + Available SF: 5,000 SF
- + Building Size: 24,000 SF
- + Loading: Grade, Rear Load

## Highlights

- Located in Eastpoint Industrial Park
- Just Off Forsyth Road with Easy Access to SR 408, SR 417, Colonial Drive and SR 436
- Close to Full Sail and the University of Central Florida
- Two Roll Up Doors
- 3-Phase Power
- 100% HVAC Office Warehouse
- New Carpet & Paint
- Clear Height: 14' - 16'
- Ample Parking



### PATRICK GOETZ

Vice President  
(407) 734.7210  
Pat@BBDRE.com

This offer is subject to errors, omissions, prior sale or withdrawal without notice.



### BISHOP BEALE DUNCAN

250 N. Orange Ave., Ste. 1500  
Orlando, FL 32801 + (407) 426.7702

[www.BBDRE.com](http://www.BBDRE.com)

# Floor & Site Plan

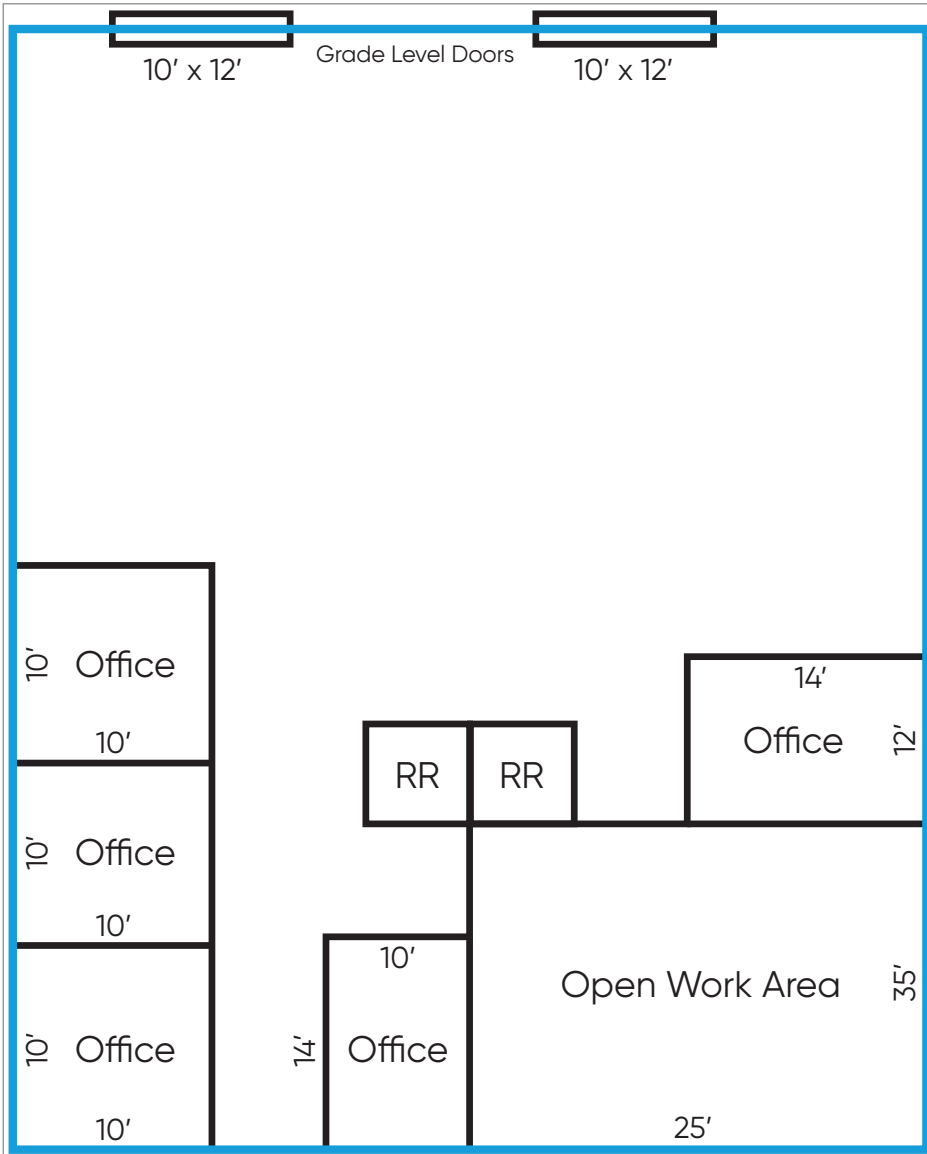

## AMENITIES

- 5 Offices
- Private Restrooms
- Open Work Area
- 2 Grade Level Loading Doors
- Clear Height: 14' - 16'



|         |         |         |         |         |         |         |                               |         |
|---------|---------|---------|---------|---------|---------|---------|-------------------------------|---------|
| Suite J | Suite I | Suite H | Suite G | Suite F | Suite E | Suite D | <b>AVAILABLE<br/>5,000 SF</b> | Suite A |
|---------|---------|---------|---------|---------|---------|---------|-------------------------------|---------|

